

ISHiGURO

Ishiguro Corporation

HISTORY OF ISHIGURO

Founded in 1939



Koji Ishiguro, the founder of Ishiguro Company Ltd(“ISHIGURO”), was born in 1916 during the World War I.

He established a valve manufacturing company (Tsuki-Fuji brand) in 1939, and built the foundation of our business.

In 1950, he also started wholesale business and contributed to postwar reconstruction though distributing building and plant materials.

Nowadays, ISHIGURO has focused on wholesale business and is a leading company with over 85-year-history in the market.

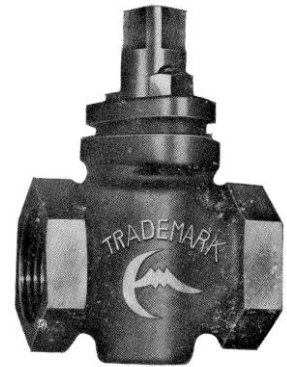

Over 85-year-history in the market

Ishiguro Corporation

Company Profile

Exchange rate: 1 USD = 130 JPY

Ishiguro Co., Ltd.

President: *Katsuji Ishiguro*

Executive Vice-President: *Koji Ishiguro*

Founded: Feb in 1939

Capital Stock: 1M USD

Head Office Location: Tokyo

Branch Office & Warehouse: 65 Offices & 54 Warehouse

Business:

- Wholesaling & Importing Valves, Piping & Fittings
- Control valve assembly
- Oil-free and degreasing products
- Repairing valves & Pressure / leakage test
- Testing & Commissioning Hydronic System

Turnover in 2022(Group) : 735M USD (JPY 95.5 Billion)

No. of employee(Group) : 1,214



Head Office



Main Warehouse



Laboratory

A leading company in the market.

Ishiguro Finance

Sales for Group Total

Unit : Million U.S. Dollar

Exchange rate: 1 USD = 130 JPY

■ Sales
— Employee

(JPY 95.5 Billion)

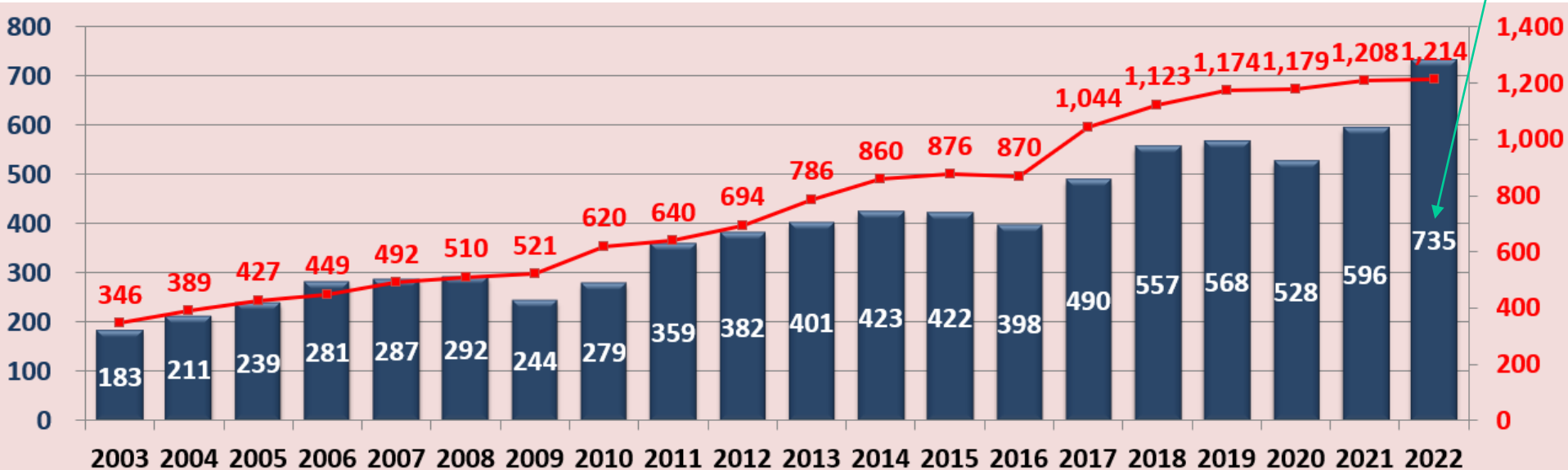

Ishiguro Distribution Network

**65 Sales Offices &
54 Warehouses**

Ishiguro : 42 ★
Group Companies : 23 ★
Total : 65 (Sales Offices)

As of July 20, 2022

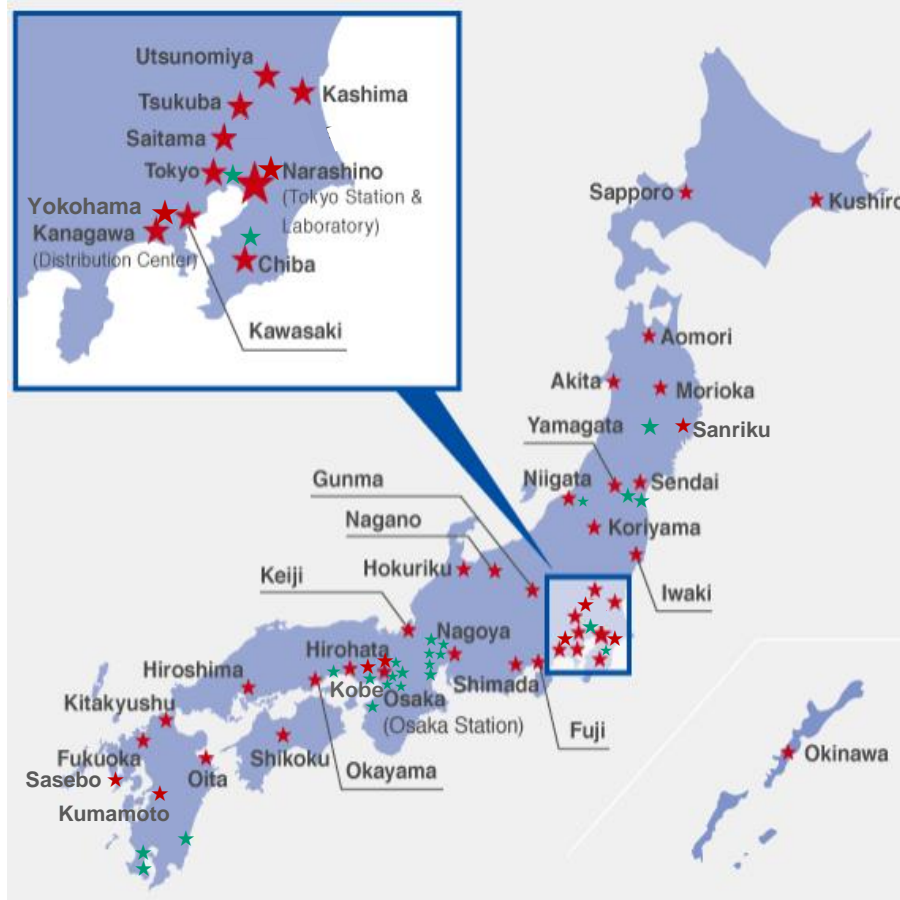

Osaka



Nagoya



Hiroshima



Fukuoka



Sapporo



Sendai



Tokyo



Chiba



Wins trust of customers with on-time delivery service.

Ishiguro Overseas business



**ISHIGURO CORPORATION
DHAKA LIAISON OFFICE**

**ISHIGURO INTERNATIONAL
CO., LTD (TOKYO, JAPAN)**

**石黒貿易（上海）有限公司
ISHIGURO INTERNATIONAL (SHANGHAI)
CO., LTD.**

PT. ISHIGURO INDONESIA

Ishiguro Business Field / Products in Line

Plant

- Petrochemical
- Steel Mills
- Thermal Power Generation
- LNG/LPG
- Heat Supply
- District Heating & Cooling

Building Application

- Hydronic System

General Industry

- Semiconductor
- Paper Manufacturing
- Textile
- Water Treatment
- Food & Beverage
- Health Care
- Medical Supplies

Carbon Pipe · Fitting · Flange

- CARBON STEEL PIPE
- MALLEABLE IRON SCREW FITTING
- CARBON STEEL BUTT - WELD FITTING
- CARBON STEEL FLANGE
- FORGED CARBON STEEL SCREW & SOCKET WELD

Stainless Pipe · Fitting · Flange

- STAINLESS STEEL PIPE
- STAINLESS STEEL SCREW FITTING
- STAINLESS STEEL BUTT - WELD FITTING
- FORGED STAINLESSSTEEL SCREW & SOCKET WELD
- STAINLESS STEEL FLANGE

Pre-Fabrication & Spool

- DESIGN / ENGINEERING
- MANUFACTURING PIPING UNIT / MODULE

Valve

- CARBON STEEL (BRONZE, BRASS, FC, FCD, SCPH)
- STAINLESS STEEL
- BUTTERFLY VALVE
- AUTOMATIC VALVE

Gasket

- RUBBER SHEET GASKET
- FLUOROCARBON RESIN GASKET
- SPIRAL WOUND GASKET
- METAL GASKET

SUS Flexible Joint · Rubber Flexible Joint

- STAINLESS STEEL FLEXIBLE HOSE
- SINGLE / DOUBLE BELLOW RUBBER FLEXIBLE JOINT

Plastic

- PLASTIC PIPE (VP, HI, HT, PLANT VP, CLEAN PIPE)
- PLASTIC FITTING (TS, HI, HT, CLEAN FITTING)
- PLASTIC VALVE (BALL VALVE, BUTTERFLY VALVE)
- INSPECTION CHAMBER

Accessories

- PRESSURE GAUGE
- TEMPERATURE GAUGE
- FLOW METER

Ishiguro Laboratory Facility

QA 1st Priority

High quality and reliability, not only **functionally** but also **visually**, is taken for granted in the market.

Pressure Testing Equipment



Laboratory



Oil-free & Degreasing Equipment



External Leakage Testing



TA, SAMSON and MANKENBERG
100% inspected.



Hydronic Testing Unit

Ishiguro is a quality & reliability-focused company.

Copyright 2023 ISHIGURO Holdings Corporation. All Rights Reserved

ISHIGURO Group

Ishiguro Product's Lineup



Dp Controller

Balancing Valves



Butterfly Valves



Control Valves Actuators

Ball Valves

Calorie Meters



Flow Meters

Temperature Sensors



Pressure Gauges

Fittings

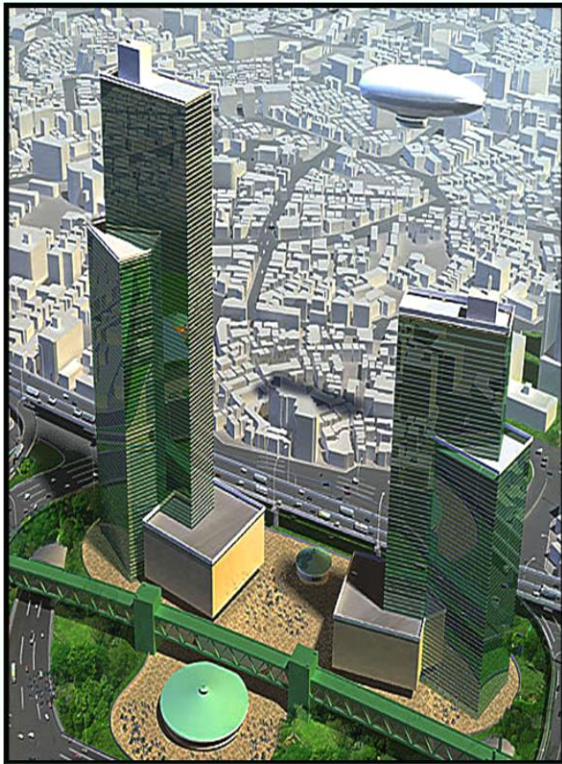

Pipes

Tubes



Ishiguro is a total system solution supplier.

Copyright 2023 ISHIGURO Holdings Corporation. All Rights Reserved

ISHIGURO Group

PRE-FABRICATION



Projects for ODA (Official Development Assistance)



Railway



Building • Hospital



Bridge • Highway



Airport

Our procurement shall be made from manufactures and mills in Japan and Overseas in pursuit of quality, long-durability, maintenance, and specification compliances.

Water Utility & Flow Instrumentation Solution



• Smart measurements for optimized operations:

- Flow (total and rate)
- Water quality
- Fluid chemistry
- Temperature and pressure
- Hydronic energy
- Cellular Data Transfer / Data Collections
- Smart Metering Analyses

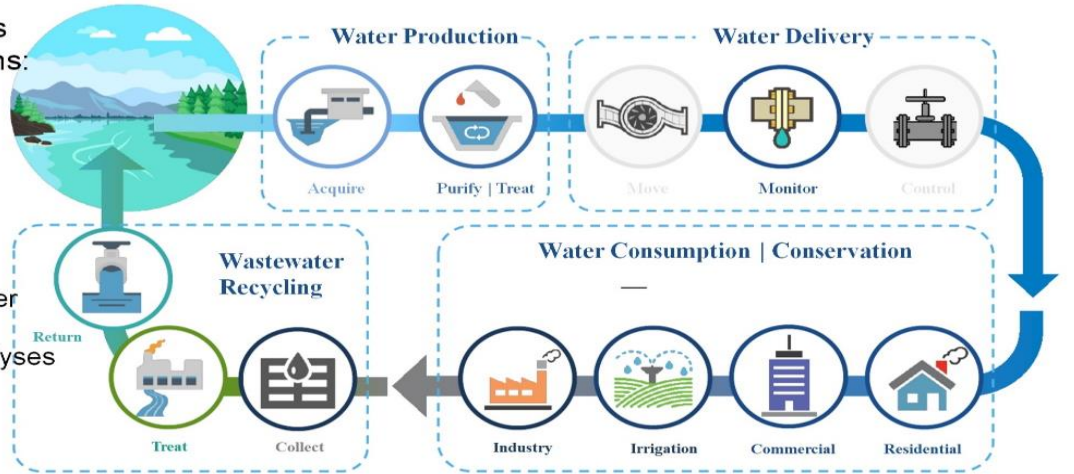

Flow Measurement and Control Materials



Electromagnetic Flow Meters



Ultrasonic Flow Meters



Variable Area Flow Meters



Turbine Meters



Oval Gear Meters



Vortex Meters



Nutating Disc Meters



Coriolis Mass Meters



Impeller Meters



Differential Pressure Flow Meters